

© NXP SEMICONDUCTORS N.V. ALL RIGHTS RESERVED	MECHANICAL OUTLINE	PRINT VERSION NOT TO SCALE
TITLE: 100LD TQFP, 14 X 14 X 1.0 PKG, 0.5 PITCH, 8.2X8.2 EXPOSED PAD	DOCUMENT NO: 98ARL10503D	REV: E
	STANDARD: JEDEC MS-026 AED-HD	
	SOT638-8	30 DEC 2015

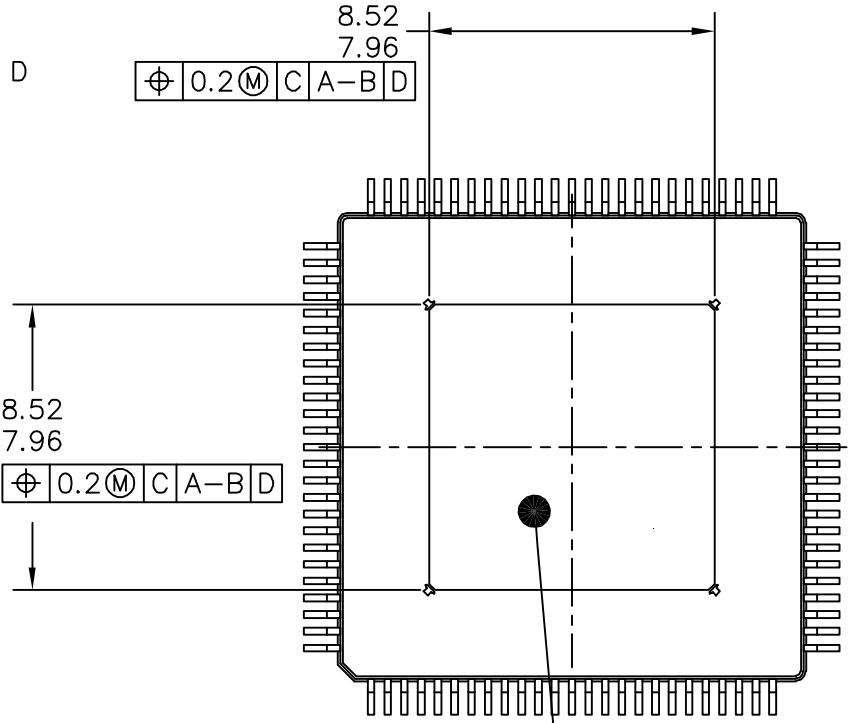

EXPOSED PAD
VIEW J-J

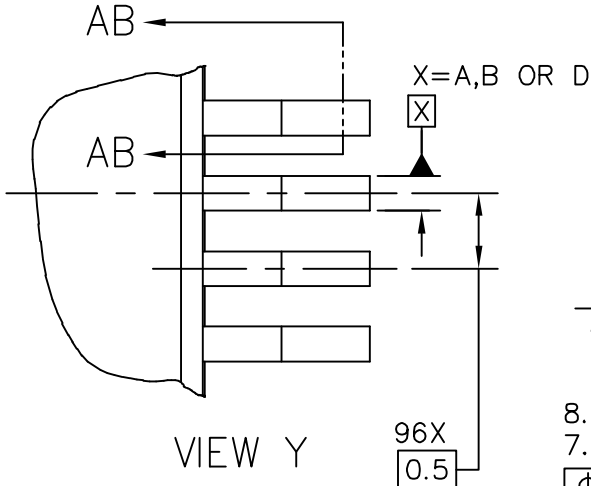
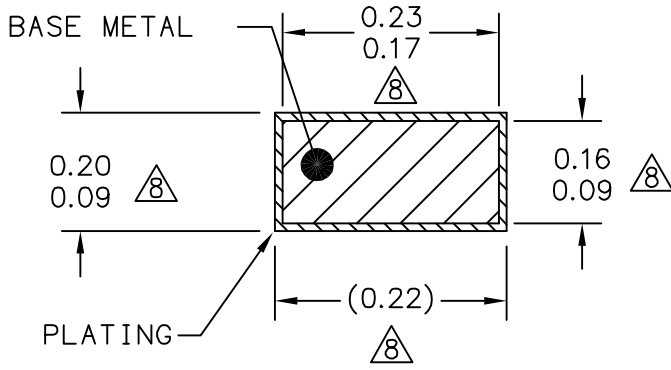

SECTION AB-AB
ROTATED 90° CW

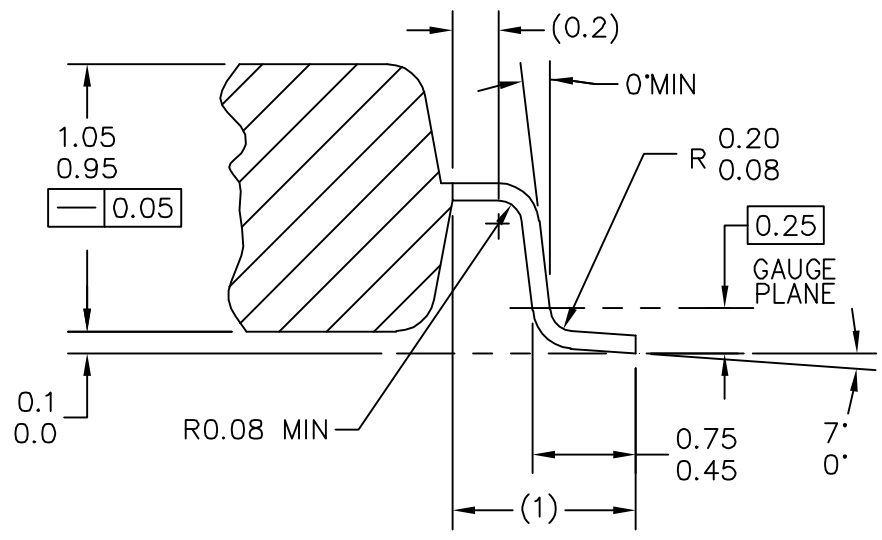

SECTION A-A

© NXP SEMICONDUCTORS N. V. ALL RIGHTS RESERVED	MECHANICAL OUTLINE	PRINT VERSION NOT TO SCALE
TITLE: 100LD TQFP, 14 X 14 X 1.0 PKG, 0.5 PITCH, 8.2X8.2 EXPOSED PAD	DOCUMENT NO: 98ARL10503D	REV: E
	STANDARD: JEDEC MS-026 AED-HD	
	SOT638-8	30 DEC 2015



NOTES:

1. DIMENSIONS ARE IN MILLIMETERS.
2. INTERPRET DIMENSIONS AND TOLERANCES PER ASME Y14.5M-1994.
3. DATUMS A, B AND D TO BE DETERMINED AT DATUM PLANE H.

4. DIMENSIONS TO BE DETERMINED AT SEATING PLANE C

5. THIS DIMENSION DOES NOT INCLUDE DAMBAR PROTRUSION. ALLOWABLE DAMBAR PROTRUSION SHALL NOT CAUSE THE LEAD WIDTH TO EXCEED THE UPPER LIMIT BY MORE THAN 0.08 mm. DAMBAR CANNOT BE LOCATED ON THE LOWER RADIUS OR THE FOOT. MINIMUM SPACE BETWEEN PROTRUSION AND ADJACENT LEAD OR PROTRUSION 0.07 mm.

6. THIS DIMENSION DOES NOT INCLUDE MOLD PROTRUSION. ALLOWABLE PROTRUSION IS 0.25 mm PER SIDE. THIS DIMENSION IS MAXIMUM PLASTIC BODY SIZE DIMENSIONS INCLUDING MOLD MISMATCH.

7. EXACT SHAPE OF EACH CORNER IS OPTIONAL.

8. THESE DIMENSIONS APPLY TO THE FLAT SECTION OF THE LEAD BETWEEN 0.10 mm AND 0.25 mm FROM THE LEAD TIP.

© NXP SEMICONDUCTORS N. V. ALL RIGHTS RESERVED	MECHANICAL OUTLINE	PRINT VERSION NOT TO SCALE	
TITLE: 100LD TQFP, 14 X 14 X 1.0 PKG, 0.5 PITCH, 8.2X8.2 EXPOSED PAD		DOCUMENT NO: 98ARL10503D	REV: E
		STANDARD: JEDEC MS-026 AED-HD	
		SOT638-8	30 DEC 2015